

# Product Information

## Mechanical dial comparator Millimes 1002

DIN  
879-1

### Product features:

- Large, high contrast dial face
- Adjustable tolerance markers
- Lockable fine adjustment screw
- Shockproof movement
- Mounting shank and measuring spindle are both made of hardened stainless steel
- Measuring spindle is mounted in a high precision ball guide for minimal hysteresis
- Resistant to lateral forces (side play) acting on the measuring spindle
- Maximum sensitivity and accuracy are ensured by the jeweled movement in conjunction with the precision gears and pinions
- Box type protective housing
- Constant measuring force
- Measuring spindle can be retracted with either a screw in cable release or with a lifting knob



Order-No.: 4335000

### Technical Data

Measuring range _beginning_ $\mu\text{m}$	-25 $\mu\text{m}$
measuring range_end_ $\mu\text{m}$	25 $\mu\text{m}$
Measuring range from	-0,025 mm
Measuring range up to	0,025 mm
Readings ( $\mu\text{m}$ )	0,5 $\mu\text{m}$
Error limit Ge ( $\mu\text{m}$ )	0,5 $\mu\text{m}$
Error limit Gges ( $\mu\text{m}$ )	0,6 $\mu\text{m}$
Error limit Gt ( $\mu\text{m}$ )	0,4 $\mu\text{m}$
Hysteresis fu ( $\mu\text{m}$ )	0,3 $\mu\text{m}$
Repeatability fw ( $\mu\text{m}$ )	0,3 $\mu\text{m}$
Measuring force	1 N
Type of dial face	25-0-25
Scale diameter	50 mm
Dial color	Yellow

### Package contains:

- case

### Dimensions

Mounting shaft	8 mm
----------------	------

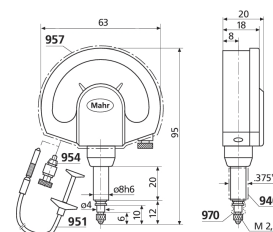

- 0 +



# Product Information

## Mechanical dial comparator Millimes 1002

### Accessories

Bezeichnung	Typ	Artikel-Nr.
Adapter bushing	940	4310103
Cable release	951	4372000
Lifting knob	954	4372030
Splash guard cover	957	4373030
Lug back	963	4375002